



Deluxe Chrome Pro  
Clipper

Deluxe Chrome Pro Clipper

Please read all instructions carefully to familiarize yourself with the Wahl Deluxe Chrome Pro Clipper before using.

Save these instructions for further reference.

For any further assistance or information call customer services on

**T:** 01227 744330

or visit

**W:** [www.wahl.co.uk](http://www.wahl.co.uk)

**E:** [customer.services@wahl.co.uk](mailto:customer.services@wahl.co.uk)

## **INDEX**

<b>IMPORTANT SAFEGUARDS</b>	Page 3
<b>USING YOUR CLIPPER</b>	Page 6
<b>USING YOUR COMPACT TRIMMER</b>	Page 14
<b>USING YOUR NASAL TRIMMER</b>	Page 15
<b>PRODUCT REGISTRATION</b>	Page 17
<b>GUARANTEE</b>	Page 19

## **IMPORTANT SAFEGUARDS**

When using this electrical appliance, especially when children are present, basic safety precautions should always be followed including the following.

### **TO REDUCE THE RISK OF FIRE AND INJURY**

1. This appliance can be used by children from aged 8 years and above and persons with reduced physical, sensory or mental capabilities, or lack of experience and knowledge, if they have been given supervision or instruction concerning use of the appliance in a safe way and understand the hazards involved. Children shall not play with the appliance. Cleaning and user maintenance shall not be made by children without supervision.
2. Switch off the appliance and unplug from outlet when not in use, before putting on or taking off attachments and also before cleaning the appliance.
3. Never use your appliance without paying attention! Always unplug the unit when not in use, even for a moment.

4. Do not operate the appliance with a broken cord or plug, or if the appliance malfunctions, or is dropped or damaged in anyway.
5. Do not wrap the cord around the appliance.
6. Any servicing or repair must be performed by an authorized service representative.
7. Do not use outdoors or in damp areas.
8. Do not let the cord hang over the edge of the work surface or let it touch any hot surfaces.
9. The use of attachments that are not supplied by the manufacturer may cause fire, electric shock or injury and damage to the appliance.
10. To protect against risk of electrical shock, never immerse the unit or let it come into contact with water or any other liquids. Do not use the unit with wet hands. If the appliance should become wet, damp or fall in water, remove plug from mains socket immediately. Do not put your hands in the water. Do not take into bathroom.
11. Never carry the unit by its power cord.

12. Do not drop or insert any object into any opening.
13. Do not let eyes or bare skin come into contact with heated surfaces.
14. Do not use with a voltage converter.
15. Allow the appliance to cool before storing away.
16. Use this appliance only for its intended purpose.

## CLIPPER MAINTENANCE

Your WAHL clipper blades were oiled and aligned before leaving our factory, however it is possible for blades to get bumped out of alignment. Blades must be realigned if they have been removed for cleaning or replacement. To determine if realignment is necessary, compare your clipper blades with this sketch.

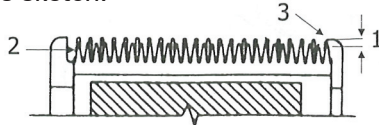

1. End of top blade teeth should be .025" to .050" (.64mm to 1.27mm) back from bottom blade. This is important so that the clipper does not cut too close or allow the moving cutter to touch the skin.
2. Extreme left hand tooth of top blade must be covering or to the left of the first small tooth of bottom blade.
3. Extreme right hand tooth of top blade must be touching the big tooth on the bottom blade.

If blade alignment is incorrect, add a few drops of oil to the blades, turn clipper on for a few moments, turn off and unplug. Loosen screws slightly and adjust. Tighten screws after blade is aligned

1. Put a few drops of wahl clipper oil on blades.
2. Bottom blade.
3. Top blade.
4. Blade slide only on adjustable blade clippers.
5. Blade lever (not on all models).
6. Power screw.
7. Switch.
8. Case.
9. Hanging loop.

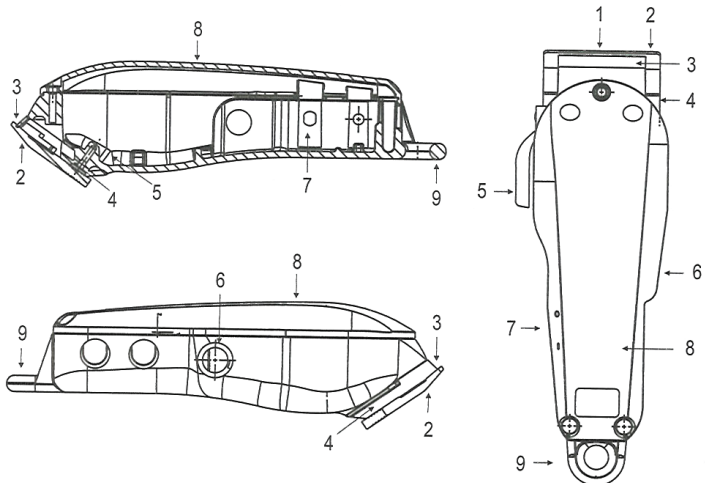

## OIL

The blades of your new clipper should be oiled every few haircuts. Simply place a few drops of oil on the teeth of the blades. Use only the WAHL oil included in the pack.

Due to the high speed of your WAHL clipper the correct type of oil must be used. Do not use hair oil, grease or any oil mixed with kerosene or any solvent as the solvent will evaporate and leave the thick oil slowing down the blades. WAHL clipper oil is very thin, natural oil which will not evaporate and will not slow down the blades.

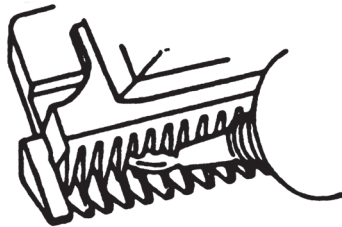

## POWER SCREW

(Not found in all models of WAHL clippers)

If your clipper has a power screw, it has been adjusted for peak efficiency before leaving the factory. However, if voltage in your home is low, you may need to re-adjust it. To adjust power, use a screwdriver or a thin coin to turn power screw in clockwise direction until the arm strikes the coil, making a noise.

Slowly turn power screw out (counter-clockwise) just until noise stops, then half turn anti clockwise. This is the maximum power setting.

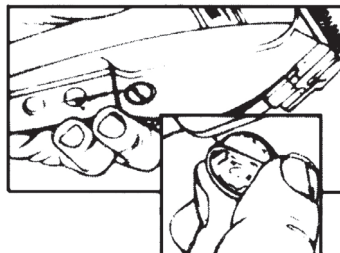

The cord should not be used to pull the clipper. Since freedom of movement needs to be maintained, care should be taken to keep the cord untwisted and unobstructed. When stored, the cord should be coiled and the unit placed in original box or storage pouch. This clipper has been designed for household use.

## TAPER LEVER

Some WAHL clippers are equipped with an adjustable taper lever. The taper lever is conveniently located near your thumb (if you are right handed) so it can easily be adjusted while the clipper is in your hand. The taper lever adds versatility to your clipper by allowing you to gradually change the closeness of your cut without an attachment comb. When the lever is in the uppermost position, the blades will give you the closest cut and leave the hair very short. Pushing the lever downward gradually increases the cutting length. In its lowermost position, the taper lever will leave the hair approximately the same length as a #1 comb (0.3cm).

Occasionally cut hair may get between the blade set and jam the blades, adjusting the taper arm will help remove the hair that has become wedged between the two blades without having to remove them. When you have finished cutting, turn the clipper on so it is running rapidly. Move the lever from "close cut" to "longer cut" a couple of times. Doing this each time you've finished using your clipper will help keep the blades clear of cut hair. If your clipper stops cutting and this does not help, your cutting blades may be dull or blunt. Either replace them or return them to WAHL for sharpening.

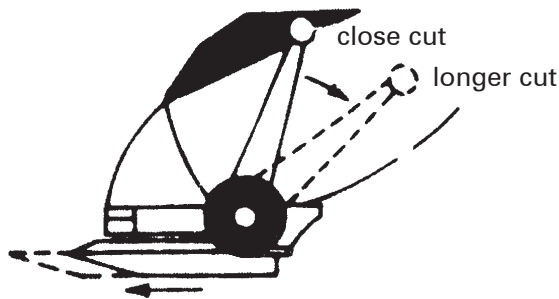

## WAHL'S GUIDE TO FOOLPROOF HOME HAIR CUTTING BEFORE YOU CUT HAIR

1. Your clipper should be clean, oiled and in perfect working condition.
2. If your kit includes a plastic cape, place it around the neck, ensuring that it is fastened securely to avoid hair falling down inside the collar. If no cape is provided in your kit, a towel will do nicely.
3. Position the person whose hair is to be cut on a stool or chair so that the top of their head is level with your eyes.
4. After combing the hair to remove all tangles, hold the clipper in a relaxed, comfortable grip with the lid facing upwards under the palm of



your hand. This grip will help you maintain comfortable, accurate cutting control.

## **CUTTING YOUR HAIR**

(for average medium to long cut)

The first time you cut the hair, cut only a small amount until you become accustomed to how long each attachment comb leaves the hair. Always start by placing the largest attachment comb on the clipper, then use shorter combs if desired length is shorter.

Remember, between professional haircuts, the hair grows evenly all over the head and a light trimming at the lower neck and sides may be all that is needed to bring that neat, well-groomed look.

Some kits do not include all WAHL attachment combs. However, these combs may be available from your dealer, or can be ordered on the order form enclosed.

## **INDIVIDUAL BLACK OR COLOUR CODED GUIDE COMBS**

Providing predetermined lengths indicated on each guide comb. Colour combs are coded for quick cutting length reference.

comb #1 (black/red) - leaves hair approx. 0.3cm in length  
comb #2 (black/purple) - leaves hair approx. 0.6cm in length  
comb #3 (black/dark blue) - leaves hair approx. 0.9cm in length  
comb #4 (black/orange) - leaves hair approx. 1.2cm in length  
comb #5 (black/yellow) - leaves hair approx. 1.6cm in length  
comb #6 (black/lavender) - leaves hair approx. 1.9cm in length  
comb #7 (black/green) - leaves hair approx. 2.2cm in length  
comb #8 (black/light blue) - leaves hair approx. 2.5cm in length  
comb #10 (black/white)- leaves hair approx. 3.1cm in length  
comb #12 (black)- leaves hair approx. 3.8cm in length

Special angle attachment combs are also available:

Right ear taper comb (black)

Left ear taper comb (black)

To attach combs, hold comb with teeth up, snap comb attachment firmly to the bottom of the clipper blade.

## EAR TRIM GUIDE COMB

Removes fear while trimming around the ears. With your clipper turned off, attach the Ear Trim Guide to your Hair Clipper just like a regular snap on guide comb. For optimum performance; rest one tine on the head, hold the clipper at approximately a 45-degree angle and slowly move the clipper around the ear (outside) working from front to back. The tine channels hair to the teeth of the clipper.

 **WARNING:** EAR TRIM GUIDE POINTS ARE SHARP. USE WITH CARE.

## EYEBROW TRIM GUIDE COMB

Trims and shapes eyebrows with an easy snap on guide comb. With the clipper turned off attach the Eyebrow Trim Guide just like a regular snap on guide comb. Starting from just above your nose slowly guide the clipper to the outside of your face, trimming in the same direction as your hair grows. This will trim and shape the longest and most unruly hair. To trim much shorter you may work from the outside of the face back towards your nose. Extra care should be used when applying this technique as it may trim much closer than you would like.

 **WARNING:** USE CARE WHEN TRIMMING THE EYEBROWS TO AVOID POKING THE EYES.

For uniform cutting allow the clipper to cut its way through the hair. Do not force it through at a faster rate.

1. Start by combing the hair so it falls into its natural direction.
2. Place the largest attachment comb onto your clipper and start by trimming the sides from the bottom upwards.

Hold the clipper lightly against the hair with teeth of the attachment comb pointing up but flat against the head. Slowly lift the clipper up and outward through the hair, cutting only a small amount at a time.



REPEAT AROUND SIDES AND BACK OF HEAD.

If you desire shorter hair, either change to a lower number attachment comb, or apply more pressure and less lift away from head with the present attachment comb.

This entire procedure requires practice, it is always better to leave too much hair the first few haircuts.



For the top of the head you will give a fairly short cut if you use the #8 (2.5cm length) attachment comb.

With the teeth flat against the head, slowly start trimming from the front to the back. Again, it is better to leave the hair longer the first few haircuts.



Longer hair on top: (no attachment comb). Use either the enclosed barber comb, or a regular comb, and lift the hair on the top of the head cutting over the comb, or grasp the hair between the fingers from the front to the back of the head, gradually cutting the hair shorter by reducing the space between the comb or fingers and the head. Comb the clients hair frequently, removing trimmed hair and checking for uneven strands.



## OUTLINING

When outlining, no attachment combs are needed. On a multi-cut clipper, push the lever up to the close-cut position. Comb hair into desired style, then starting between the ear and the sideburns as shown, hold clipper with corner edge of blade against the hair-line.

Slowly follow the desired outline of the hair over, around and behind the ears. For defining sideburns and the back of the neck, hold the clipper upside down, as shown, and hold against the skin at the desired length and move down. Comb hair and check that sides are even. Check for uneven spots throughout the haircut and amend if required.

## SHORT TAPERED STYLES

If a short tapered cut on the sides and back is desired, follow this diagram:



## INSTRUCTIONS FOR CUTTING MEN'S AND BOY'S HAIR CREW CUTS AND SHORT CUTS

Starting with the desired attachment comb, cut from the back of the neck to the crown. Hold the attachment comb flat against the head and slowly move the clipper through the hair as shown.

## Deluxe Chrome Pro Clipper

Use the same procedure from the lower side to the upper side of the head, as shown. Then cut the hair against the direction in which it grows from the front to the crown and even up the cut with the sides.

To give a 'flat top' look, the hair on top of the head must be cut over the top of a flat top comb rather than using the attachment comb.

Use closer cutting attachment combs to "taper" the hair down to the neckline as desired. Comb hair and check for uneven spots and outline sideburns and neckline as previously described.

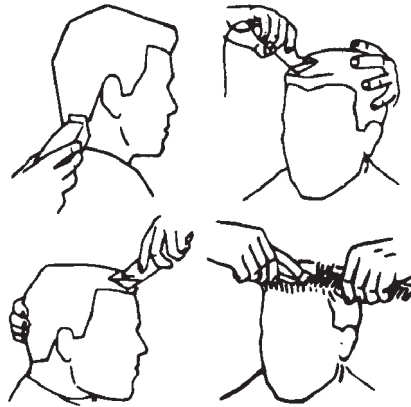

The four basic areas illustrated on the Wahl Cutting Guide are your "road map" to easy do-it-yourself hair cutting.

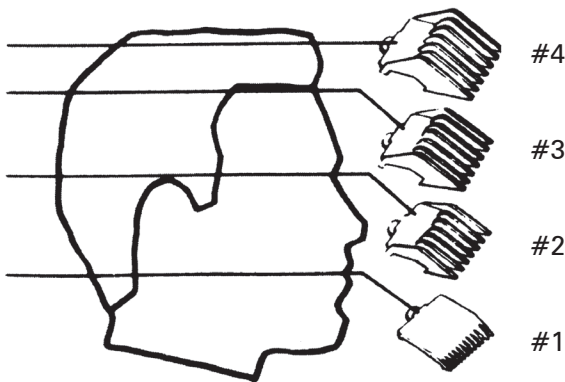

## WIRING

 **WARNING:** IF THE SUPPLY CORD IS DAMAGED IT MUST BE REPLACED BY THE MANUFACTURERS SERVICE AGENT OR A SIMILARLY QUALIFIED PERSON IN ORDER TO AVOID A HAZARD.

The wires in the mains lead of this Clipper are coloured in accordance to the following code:

Blue Neutral (N)

Brown live (L)

This appliance is fitted with a 3 pin plug which has a 3amp fuse fitted.

If the plug supplied is not suitable for your socket or becomes damaged, it should be cut off and disposed of, and a suitable plug fitted as detailed below.

As the colours of the wires in the mains lead of this Clipper may not correspond with the colour markings identifying the terminals in your plug, proceed as follows.

The wire which is coloured BLUE must be connected to the terminal in the plug which is marked with the letter 'N' or coloured BLACK or BLUE.

The wire which is coloured BROWN must be connected to the terminal in the plug which is marked with the letter 'L' or coloured RED or BROWN.

If a 13 amp (BS 1363) plug is used, a 3 amp fuse must be fitted. If any other type of plug is used, a 5 amp fuse must be fitted either in the plug or adaptor at the distribution board.

Replacement fuses should be approved to BS 1362.

Fuse cover must be refitted when changing the fuse. If fuse cover is lost, the plug must not be used until a replacement is obtained. Information for obtaining the correct fuse is marked on the carrier itself and in the bottom of the fuse cavity in the plug. These may be obtained by Wahl UK Ltd.

**NEITHER WIRE MUST BE CONNECTED TO THE EARTH TERMINAL OF A THREE PIN PLUG. ANY ERROR IN CONNECTION THE APPLIANCE INVALIDATES THE GUARANTEE**

## **WAHL COMPACT TRIMMER OPERATING INSTRUCTIONS**

### Battery Installation/Replacement

1. Holding the trimmer with the cutting head facing you, place your thumb on the arrow moulded into the battery compartment cover, press lightly and slide cover downward to remove it.
2. Insert 1 AA battery (included)
3. Replace the battery compartment cover
4. Replace the battery as soon as you notice the trimmer is running slower than normal to avoid pulling hairs.

### Using your Trimmer

Your Wahl trimmer is ideal for outlining, touch ups and fine detailing. To trim around ears slowly and carefully follow the desired outline of the hair, over, around and behind the ears.

For defining sideburns, and the back of the neck, hold the trimmer upside down, against the skin of the desired length and move down.

## **CLEANING AND MAINTENANCE CARING FOR YOUR TRIMMER**

### Blade Care

Trimmer blades have precision-hardened, ground and lapping cutting teeth. Blades should be handled carefully and never bumped or used to cut dirty abrasive material.

Should your trimmer blades become damaged or dull, you may purchase a new blade assembly from Wahl. Be sure to ask for the Groomsman blade assembly.

### Oiling Blades

For best results, put one or two drops of Wahl clipper oil on the blades in the areas highlighted on page 6. Oil the blades only when necessary or approximately once a month. When oiling your trimmer, turn the trimmer "On", hold the unit with the blades facing down and squeeze one or two drops of Wahl Clipper oil onto the blades. Wipe of excess oil with a cloth.

### **NOTICE - DO NOT OVER OIL**

Excessive oiling or application of liquids will damage if allowed to seep

back into the motor.

## **CLEANING AND STORAGE**

Before storing your trimmer, use the cleaning brush to whisk any loose hairs from the units and blades. Store unit in a manner so that the blades are protected from damage.

## **WAHL NASAL TRIMMER OPERATING INSTRUCTIONS**

Battery Installation/Replacement:

1. Holding the trimmer with the cutting head facing you, place your thumb on the arrow moulded into the battery compartment cover, press lightly and slide the cover downward to remove it.
2. Insert one AA battery, (included) positive end first (towards the cutting head)
3. Replace the battery compartment cover.
4. To maximise the battery life, turn the trimmer "Off" immediately.
5. Replace the battery as soon as you notice the trimmer running slower than normal, to avoid pulling hairs.

Trimming Hair From Nose.

1. Makes sure nasal passages are clean
2. Slowly move rotary head in and out of each nostril, no more than 1/4 inches deep. Keep the side of the cutting head firmly against the skin to prevent a tickling sensation

Trimming Hair From Ears

1. Make sure the outer areas do not contain any wax.
2. Hold the ear flat with one hand and carefully insert rotary head no more than 1/4 inches into the outer ear.

 **WARNING:** DO NOT INSERT THE ROTARY HEAD OR ANY OTHER FOREIGN OBJECT INTO THE INNER EAR. FOR HAIR GROWING ON THE OUTSIDE OF THE EAR, SIMPLY MOVE THE ROTARY HEAD SLOWLY ALONG THE EDGES OF THE EAR.

## **CLEANING AND MAINTENANCE**

1. Periodically after use, turn the trimmer "Off" and rinse cutting head under warm running water.
2. For more thorough cleaning , remove the attached cutting head by turning it slightly counter clockwise. Then rinse the entire cutting head under running water. After cleaning, replace cutting head by turning slightly clockwise and wipe the entire trimmer dry with a soft cloth. Always replace the protective cap before storing.



## **PRODUCT REGISTRATION**

Wahl are constantly developing and launching new products in the UK. We would like to understand your product needs and expectations and we value any comments you may have. As part of Wahl Customer Care, we are offering you the chance to be kept up to date with the latest product launches, innovations and special offers.

Please take a minute to register your product online at [www.wahl.co.uk](http://www.wahl.co.uk).

**WASTE ELECTRICAL & ELECTRONIC EQUIPMENT DIRECTIVE 2002/96/EC  
(WEEE)**



At the end of this products life it should not be disposed of with general household waste.

Care should be taken to dispose of in a suitable manner in accordance with your Local Authority regulation.

## **GUARANTEE**

This product is guaranteed against defects in material and workmanship for a period of 3 years from the date of original purchase or receipt as a gift.

Should this product become defective during the guarantee period, return it to the store of purchase together with your proof of purchase for repair or replacement.

Alternatively within the guarantee period you can return the product to Wahl (UK) Ltd who will repair any such defect or elect to replace the product or any part of it, without charge, provided there is proof of purchase. Should a replacement be offered this will not extend the original guarantee period.

The guarantee becomes invalid in the case of misuse, alteration or repair by unauthorised persons.

This guarantee in no way affects your rights under law in the United Kingdom.

Wahl (UK) Ltd  
Herne Bay Trade Park  
Herne Bay  
Kent  
CT6 8JZ  
[www.wahl.co.uk](http://www.wahl.co.uk)

Customer Service **T: 01227 744330**

Form No. ZA449  
Rev3 11-12