



**LITHIUM ION
RECHARGEABLE CLIPPER
INSTRUCTIONS**

RECHARGEABLE CLIPPER

Please read all instructions carefully to familiarise yourself with your new clipper before using.

Save these instructions for further reference.

For any further assistance or information call Customer Services on

T: 01227 740066

or visit

W: www.wahl.co.uk

E: customer.services@wahl.co.uk

CONTENTS

GENERAL USER INFORMATION	Page 3
IMPORTANT SAFEGUARDS	Page 4
OPERATING INSTRUCTIONS	Page 7
CARE AND CLEANING	Page 9
WIRING	Page 10
DISPOSAL	Page 10
GUARANTEE	Page 11

GENERAL USER INFORMATION

Information about using the operation manual

- ▶ Before using the appliance for the first time, you must read and understand the operation manual completely.
- ▶ Consider the operation manual as part of the product and store it in a safe and accessible place.
- ▶ Include this operation manual if passing the appliance on to a third party.
- ▶ In the case of conflicts with national safety specifications or instructions, the national requirements must be followed.

Explanation of symbols and notes



DANGER

Danger of electric shock which may result in serious physical injury or death.



DANGER

Danger of explosion which may result in serious physical injury or death.



WARNING

Warning of possible physical injury or a health risk.



CAUTION

Information about danger of material damage.



Note with useful information and tips.

- ▶ Action to be taken by owner.
1. Carry out these actions in the sequence described.
- List

RECHARGEABLE CLIPPER

Please retain this leaflet for future reference.

READ ALL INSTRUCTIONS BEFORE USING.

IMPORTANT SAFEGUARDS

When using this electrical appliance, especially when children are present, basic safety precautions should always be observed including the following.

Requirements

- ▶ Read the instruction manual in full to familiarize yourself with the product before the first use.
- ▶ This appliance can be used by children from aged 14 years and above and persons with reduced physical, sensory or mental capabilities, or lack of experience and knowledge, if they have been given supervision or instruction concerning use of the appliance in a safe way and understand the hazards involved. Children shall not play with the appliance. Cleaning and user maintenance shall not be made by children without supervision.
- ▶ Use this appliance only for its intended purpose.

Hazards



Danger! Electric shock due to damage to appliance

- ▶ Do not operate the appliance with a broken cord, plug or charger, or if the appliance malfunctions, or is dropped or damaged in anyway.
- ▶ Any servicing or repair must be performed by an authorized service representative.
- ▶ The use of attachments that are not supplied by the manufacturer may cause fire, electric shock or injury and damage to the appliance.



Danger! Electric shock due to penetration of liquid.

- ▶ To protect against risk of electrical shock, never immerse the unit or let it come into contact with water or any other liquids. Do not use the unit with wet hands. If the appliance should become wet, damp or fall in water, remove plug from mains socket immediately. Do not put your hands in the water. Do not take into bathroom.



Danger of explosion

- ▶ Never use the appliance where aerosol (spray) products are being used or where oxygen is released.

RECHARGEABLE CLIPPER

- ▶ Exhausted batteries/ rechargeable batteries should not be disposed of in the household waste. Dispose of them in a completely discharged state in accordance with local legal regulations. Do not throw into fire where heat could cause them to rupture.



Warning! Injuries due to incorrect handling

- ▶ Switch off the appliance and unplug from outlet when not in use, before putting on or taking off attachments and also before cleaning the appliance.
- ▶ Never use your appliance without paying attention! Except when charging always unplug this appliance from the electricity outlet immediately after using.



Caution! Danger of product damage

- ▶ Do not wrap the cord around the appliance / charger.
- ▶ Do not use outdoors or in damp areas.
- ▶ Never carry the unit by its power cord.
- ▶ Do not drop or insert any object into any opening.

RECHARGEABLE CLIPPER

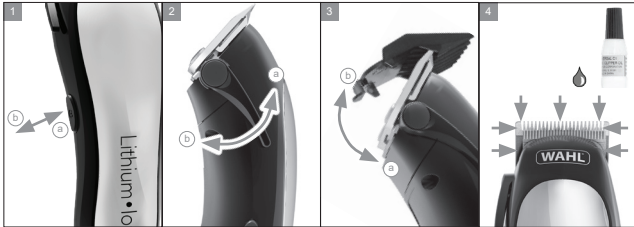

OPERATING INSTRUCTIONS

CHARGING THE BATTERY

Before the equipment is used for the first time, it should be charged 3-5 hours. Plug power cord directly into unit. Be sure clipper is switched OFF when charging. During charging, the charge indicator is illuminated. The charge indicator will begin to blink when almost fully charged and may shut off when fully charged.

When the battery is fully charged the equipment can be used for up to 120 minutes continuous run time.



Avoid pressing the blades strongly against the skin, being especially careful around the ears. (The blades should be directed towards the skin at the right angle, but without significant pressure)

CHARGING PRECAUTIONS

1. Only charge the device when charging is required. A charge is required when the product begins to slow down or has trouble maintaining speed while performing its intended function. (Note: If the product is cord/cordless, and you should run out of charge, you may continue running the device corded to complete your task)

RECHARGEABLE CLIPPER

- 2.If the device is fully discharged, apply a charge right away to prevent damage or inability to recharge.
- 3 A partial charge is fine; Li-Ion does not require a full charge.
- 4.Charge the device at moderate temperatures. Do not charge below freezing.
- 5.If a charging stand is included, limit the time the product remains at full charge in the stand, especially if warm.
- 6.Do not leave the device connected to the charger, or sitting in the charge stand, when the charger is not plugged into an outlet for charging. (Note: It's okay to leave the device in its stand for storage if the stand allows for the charger to be disconnected from the stand or product)
- 7.Perform regular maintenance on the device including keeping the blades oiled, clean, and free of debris to prevent taxing the battery.

TROUBLESHOOTING

If your clipper does not seem to take a charge, check the following before returning it for repair:

- 1.Check outlet to make sure it is working by plugging in another appliance.
- 2.Be sure the clipper is properly connected to the recharging transformer, all connections are secure and the switch on the clipper is turned OFF.
- 3.If your electricity is connected to a master power switch, we suggest the clipper be disconnected from the charger anytime the master switch is off. Leaving the unit plugged into a dead outlet or an unplugged charger will drain the battery.
- 4.If the clipper does not run and is completely charged, turn the unit ON and pinch or push the blades manually. (Oil may have dried out between the blades, so they may be temporarily stuck together)

ATTACHMENTS

To attach the combs, hold comb with teeth up and snap it firmly to the bottom of the clipper blade. (Fig. 3) For uniform cutting, allow the clipper to cut its way through the hair. Do not force it through at a faster rate.

RECHARGEABLE CLIPPER

TAPER LEVER

Some clippers are equipped with an adjustable taper lever that changes the closeness of your cut. When the lever is in the uppermost position, the blades will give the closest cut (Fig. 2a) Pushing the lever downward gradually increases the cutting length (Fig. 2b)

LITHIUM-ION BATTERY REPLACEMENT

This product uses a lithium-ion battery. For proper disposal of this appliance, please refer to disposal section on page 10. For battery replacement send the entire, intact clipper unit to Wahl (UK) Limited. Do not attempt to remove the battery. Lithium-Ion batteries can explode, catch fire, and/or cause burns if disassembled, damaged, or exposed to water or high temperatures.

If you choose not to replace the battery, the entire, intact clipper must be disposed. Do not attempt to remove the battery for disposal. Lithium-Ion batteries may be subject to local disposal regulations.

CARE AND CLEANING



- Always disconnect the appliance from the wall socket before any cleaning operation.
- It is normal for the unit to become somewhat warm during normal use.
- To clean the unit, use either a clean dry or dampened cloth. Do not use abrasive cleaning agents or scrub pads. Do not use alcohol or solvents.
- To remove hair from between the blades, use the cleaning brush provided.
- After each use, blades should be cleaned and oiled. Put a small drop of Wahl Clipper Oil between the blades while the trimmer is running. Wipe off excess oil so it does not run into the motor.(Fig.4)
- Do not store the trimmer in a wet or moist environment.
- Never immerse the appliance in water or any other liquid.
- When the clipper is not in use, the blade guard attachment should be in place to protect the blades.

RECHARGEABLE CLIPPER

WIRING



WARNING: IF THE TRANSFORMER IS DAMAGED IT MUST BE REPLACED BY THE MANUFACTURERS SERVICE AGENT OR A SIMILARLY QUALIFIED PERSON IN ORDER TO AVOID A HAZARD.

THIS PRODUCT MUST ONLY BE USED WITH THE TRANSFORMER SUPPLIED. SHOULD A REPLACEMENT BE REQUIRED PLEASE CONTACT WAHL CUSTOMER SERVICES.

DISPOSAL



Handle with care! Environmental damage in the case of incorrect disposal.

Correct disposal will ensure environmental protection and prevent any potentially harmful impacts on people and the environment.

Adhere to the relevant legal requirements when disposing of the appliance.

Information on the disposal of electrical and electronic appliances in the European Community:



Within the European Community, national regulations are specified for the disposal of electrical appliances, based on EU Waste Electrical and Electronic Equipment Directive 2002/96/EC (WEEE). In accordance with this, the appliance can no longer be disposed of with the local or domestic waste.

The appliance will be accepted free of charge by local collection points or recycling centres.

GUARANTEE

This product is guaranteed against defects in material and workmanship for a period of five years from the date of original purchase or receipt as a gift.

Should this product become defective during the guarantee period, return it to the store of purchase together with your proof of purchase for repair or replacement.

Alternatively within the guarantee period you can return the product to Wahl (UK) Ltd who will repair any such defect or elect to replace the product or any part of it, without charge, provided that there is proof of purchase. Should a replacement be offered this will not extend the original guarantee period.

The guarantee becomes invalid in the case of misuse, alteration or repair by unauthorised persons.

This guarantee does not include blades, cables, shaver heads, foils and cutters etc which are consumable parts.

This product is design for domestic use only and use within a professional environment will invalidate the guarantee.

This guarantee in no way affects your rights under statutory law in the United Kingdom.

WAHL (UK) LTD
STERLING HOUSE
CLIPPER CLOSE
RAMSGATE, KENT
CT12 5GG

CUSTOMER SERVICES T: 01227 740066
www.wahl.co.uk

Form No. ZB001
Rev.4 09-18