



P R O F E S S I O N A L

**RECHARGEABLE TRIMMER  
INSTRUCTIONS**

## RECHARGEABLE TRIMMER

Please read all instructions carefully to familiarise yourself with your new trimmer before using.

Save these instructions for further reference.

For any further assistance or information call Customer Services on

T: 01227 740066

or visit

W: [www.wahl.co.uk](http://www.wahl.co.uk)

E: [customer.services@wahl.co.uk](mailto:customer.services@wahl.co.uk)

## CONTENTS

<b>GENERAL USER INFORMATION</b>	Page 3
<b>IMPORTANT SAFEGUARDS</b>	Page 5
<b>OPERATING INSTRUCTIONS</b>	Page 8
<b>CLEANING &amp; MAINTENANCE</b>	Page 9
<b>WIRING</b>	Page 9
<b>BATTERY REPLACEMENT, REMOVAL AND DISPOSAL</b>	Page 9
<b>GUARANTEE</b>	Page 11

## GENERAL USER INFORMATION

Information about using the operation manual

- ▶ Before using the appliance for the first time, you must read and understand the operation manual completely.
- ▶ Consider the operation manual as part of the product and store it in a safe and accessible place.
- ▶ Include this operation manual if passing the appliance on to a third party.
- ▶ In the case of conflicts with national safety specifications or instructions, the national requirements must be followed.

Explanation of symbols and notes



**DANGER**

Danger of electric shock which may result in serious physical injury or death.



**DANGER**

Danger of explosion which may result in serious physical injury or death.



**WARNING**

Warning of possible physical injury or a health risk.



**CAUTION**

Information about danger of material damage.



Note with useful information and tips.

- ▶ Action to be taken by owner.
1. Carry out these actions in the sequence described.
- List

## RECHARGEABLE TRIMMER

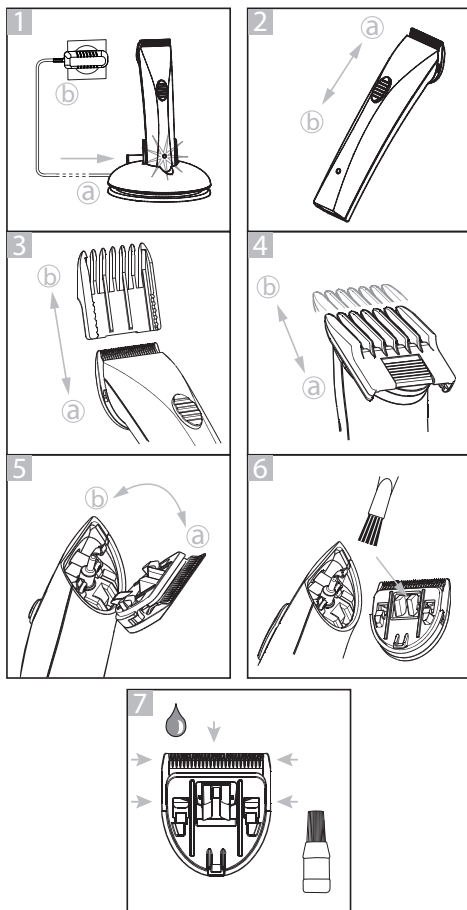

Please retain this leaflet for future reference.

**READ ALL INSTRUCTIONS BEFORE USING.**

## **IMPORTANT SAFEGUARDS**

When using this electrical appliance, especially when children are present, basic safety precautions should always be observed including the following.

### **Requirements**

- ▶ Read the instruction manual in full to familiarise yourself with the product before the first use.
- ▶ This appliance can be used by children from aged 14 years and above and persons with reduced physical, sensory or mental capabilities, or lack of experience and knowledge, if they have been given supervision or instruction concerning use of the appliance in a safe way and understand the hazards involved. Children shall not play with the appliance. Cleaning and user maintenance shall not be made by children without supervision.
- ▶ Use this appliance only for its intended purpose.

## Hazards



### **Danger! Electric shock due to damage to appliance**

- ▶ Do not operate the appliance with a broken cord, plug or charger, or if the appliance malfunctions, or is dropped or damaged in anyway.
- ▶ Any servicing or repair must be performed by an authorized service representative.
- ▶ The use of attachments that are not supplied by the manufacturer may cause fire, electric shock or injury and damage to the appliance.



### **Danger! Electric shock due to penetration of liquid.**

- ▶ To protect against risk of electrical shock, never immerse the unit or let it come into contact with water or any other liquids. Do not use the unit with wet hands. If the appliance should become wet, damp or fall in water, remove plug from mains socket immediately. Do not put your hands in the water. Do not take into bathroom.



### **Danger of explosion**

- ▶ Never use the appliance where aerosol (spray) products are being used or where oxygen is released.

- ▶ Exhausted batteries/ rechargeable batteries should not be disposed of in the household waste. Dispose of them in a completely discharged state in accordance with local legal regulations. Do not throw into fire where heat could cause them to rupture.



**Warning! Injuries due to incorrect handling**

- ▶ Switch off the appliance and unplug from outlet when not in use, before putting on or taking off attachments and also before cleaning the appliance.
- ▶ Never use your appliance without paying attention! Except when charging always unplug this appliance from the electricity outlet immediately after using.



**Caution! Danger of product damage**

- ▶ Do not wrap the cord around the appliance / charger.
- ▶ Do not use outdoors or in damp areas.
- ▶ Never carry the unit by its power cord.
- ▶ Do not drop or insert any object into any opening.

## RECHARGEABLE TRIMMER

### OPERATING INSTRUCTIONS

Before the appliance is used for the first time it should be charged for 16 hours.

#### CHARGING THE RECHARGEABLE BATTERY

Connect the plug-in transformer to the power supply (fig1). Ensure the appliance is switched off, otherwise it cannot be charged (fig2b).

Place the appliance on the charging stand. Whilst charging the charging indicator will illuminate.

The charger indicator will go out when removed from the charging stand.

We recommend you only charge your appliance when its performance has deteriorated noticeably.

Longer charging times do not damage the appliance.

It takes approximately 16 hours for the appliance to be fully charged.

Use only the charging transformer supplied with this kit, DO NOT attempt to charge with any other transformer.

#### OPERATION OF RECHARGEABLE BATTERY

Using the ON/OFF switch, switch on the appliance (fig 2a)  
Switch off immediately after use.

#### ATTACHMENT COMB

Your appliance is supplied with a variable attachment comb. The attachment comb has five settings. The further the attachment comb is pressed on to the appliance the shorter the cutting length. In this way the cutting length can be varied between 3-6mm (fig 3).

To attach the comb, attach on to the appliance in the direction of the arrow until it locks into position (fig 4a).

To remove push the comb in the direction of the arrow (fig 4b)

#### CHANGING THE BLADE SET

The blade set can be removed by pushing the blade set away



## RECHARGEABLE TRIMMER

from the housing in the direction of the arrow see (fig 5a).  
To replace blade set position it with the hook in the slot on the housing and press until it clicks into place (fig 5b).

### CLEANING AND MAINTENANCE

#### **Never immerse the appliance in water.**

Remove the attachment comb after each use and clean the blade set using the cleaning brush.

Remove the blade set (fig 5) and clean the blade, press the cleaning lever (see fig 6). This allows you to remove any hairs and dirt between top and bottom blade with the cleaning brush (easy cleaning).

The charging contacts of the appliance must be kept clean. Use only a slightly damp cloth for cleaning the housing and charging stand never use solvents or scouring agents.

Oil the blade set regularly using the oil supplied (fig 7) to maintain the cutting performance and ensure a long service life. Replace the attachment comb to protect the blade when not in use.

The blade set should be replaced if cutting performance is reduced after extended use.

### WIRING



**WARNING:** If the transformer is damaged it must be replaced by the manufacturers service agent or a similarly qualified person in order to avoid a hazard.

This product must only be used with the transformer supplied, Should a replacement be required contact Wahl customer services.

### BATTERY REPLACEMENT, REMOVAL AND DISPOSAL

#### BATTERY REPLACEMENT

For battery replacement the entire, intact trimmer should be sent to: Wahl (UK) Ltd Customer Services (the address can be found on the reverse of this booklet) or taken to a suitably qualified professional. The battery should only be replaced by the original manufacturers spare.

## RECHARGEABLE TRIMMER

### BATTERY REMOVAL AND DISPOSAL

At the end of its life, when it will no longer take a full charge, the battery in your trimmer must be removed and recycled/disposed of correctly. Batteries should be disposed of at an official collection point. If you are having trouble removing the battery you can also return the product to Wahl (UK) Ltd Customer Services who will dispose of it in an environmentally safe way.

To remove the battery follow these steps:

1. Unplug the transformer from the outlet, disconnect from trimmer and allow the batteries to completely run down before disassembly.
2. Remove the blade
3. Using a Torx 7 screwdriver, remove the 2 screws found under the blade
4. Prise the trimmer apart along the join in the housing
5. Remove the motor and PCB assembly
6. Remove the battery by prizing up from the PCB (be careful not to puncture the battery)
7. Apply tape to both ends of the battery before recycling/dispersing.

### DISPOSAL



**Handle with care! Environmental damage in the case of incorrect disposal.**

Correct disposal will ensure environmental protection and prevent any potentially harmful impacts on people and the environment.

Adhere to the relevant legal requirements when disposing of the appliance.

**Information on the disposal of electrical and electronic appliances in the European Community:**



Within the European Community, national regulations are specified for the disposal of electrical appliances, based on EU Waste Electrical and Electronic Equipment Directive 2012/19/EU (WEEE). In accordance with this, the appliance can no longer be disposed of with the local or domestic waste.

The appliance will be accepted free of charge by local collection points or recycling centres.

## RECHARGEABLE TRIMMER

### **GUARANTEE**

This product is guaranteed against defects in material and workmanship for a period of 1 year from the date of original purchase or receipt as a gift.

Should this product become defective during the guarantee period, return it to the store of purchase together with your proof of purchase for repair or replacement.

Alternatively within the guarantee period you can return the product to Wahl (UK) Ltd who will repair any such defect or elect to replace the product or any part of it, without charge, provided that there is proof of purchase. Should a replacement be offered this will not extend the original guarantee period.

The guarantee becomes invalid in the case of misuse, alteration or repair by unauthorised persons.

This guarantee does not include blades, cables, shaver heads, foils and cutters etc which are consumable parts.

This guarantee in no way affects your rights under statutory law in the United Kingdom.

WAHL (UK) LTD  
STERLING HOUSE  
CLIPPER CLOSE  
RAMSGATE, KENT  
CT12 5GG

CUSTOMER SERVICES T: 01227 740066  
[www.wahl.co.uk](http://www.wahl.co.uk)

Form No. ZB037 Rev.5 10/21