

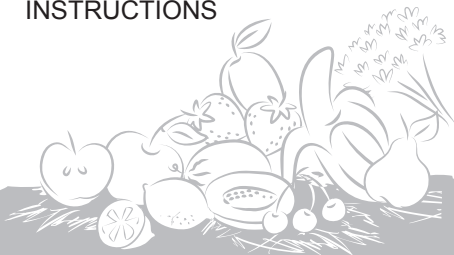

ZX805

TABLE BLENDER WITH GRINDER

INSTRUCTIONS



SAFETY FIRST:

Never touch the blades while the appliance is plugged in. Always read your instructions before using for the first time.

Please read all instructions carefully to familiarise yourself with the Wahl Table blender and grinder before using.

**THIS TABLE BLENDER & GRINDER IS
INTENDED FOR HOUSEHOLD
USE ONLY.**

Save these instructions for further reference

For any further assistance or information
call customer services on

T: 01227 740066

or visit

W: www.wahl.co.uk

E: customer.services@wahl.co.uk

CONTENTS

| | |
|-------------------------------|----------------|
| DESCRIPTION OF PARTS | Page 3 |
| IMPORTANT SAFEGUARDS | Page 4 |
| BEFORE USE | Page 10 |
| HOW TO USE | Page 11 |
| CLEANING & STORAGE | Page 13 |
| PRODUCT REGISTRATION | Page 15 |
| GUARANTEE | Page 15 |
| WIRING | Page 16 |

Description of parts

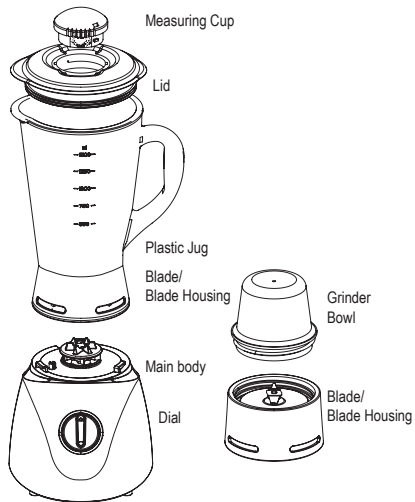

Please read this instruction manual carefully and familiarise yourself with your new Table Blender with Grinder before using for the first time. Please retain these instructions for future reference.

Explanation of symbols and notes

**DANGER**

Danger of electric shock which may result in serious physical injury or death.

**DANGER**

Danger of explosion which may result in serious physical injury or death.

**WARNING**

Warning of possible physical injury or a health risk.

**CAUTION**

Information about danger of material damage.



Note with useful information and tips.

- ▶ Action to be taken by owner.
- 1. Carry out these actions in the sequence described.
- List

IMPORTANT SAFEGUARDS

When using your electrical appliance, basic safety precautions should always be followed, including the following:

Requirements

- ▶ Read the instruction manual in full to familiarise yourself with the product before the first use.
- ▶ This appliance shall not be used by children. Keep the appliance and its cord out of reach of children.
- ▶ This appliance can be used by persons with reduced physical, sensory or mental capabilities, or lack of experience and knowledge, if they have been given supervision or instruction concerning use of the appliance in a safe way and understand the hazards involved.
- ▶ Children shall not play with the appliance.
- ▶ Use this appliance only for its intended purpose.

Hazards

Danger! Electric shock due to damage to appliance.

- ▶ Do not operate the appliance with a broken cord or plug, or if the appliance malfunctions, or is dropped or damaged in anyway.
- ▶ Any servicing or repair must be performed by an authorized service representative.
- ▶ Only use the attachments supplied with this product. The use of attachments that are not supplied by the manufacturer may cause fire, electric shock or injury and damage to the appliance.

 Danger! Electric shock due to penetration of liquid

- ▶ To protect against risk of electrical shock, never immerse the unit or let it come into contact with water or any other liquids. Do not use the unit with wet hands. If the appliance should become wet, damp or fall in water, remove plug from mains socket immediately. Do not put your hands in the water.

 Warning! Injuries due to incorrect handling

- ▶ Switch off the appliance and unplug from outlet when not in use, before putting on or taking off attachments and also before cleaning the appliance.
- ▶ Never touch or allow contact with moving parts while in motion, keep hands, hair, clothing and other utensils

away from the moving parts during operation to prevent an accident, injury or damage to the appliance.

- ▶ Always cool hot liquids before blending.
- ▶ The blades are extremely sharp, handle with care.
- ▶ Only use the unit with the lid tightly closed.

 **Caution! Danger of product damage**

- ▶ Never use your appliance without paying attention! Always unplug this appliance from the electricity outlet immediately after use or when left unattended.
- ▶ Do not let the cord hang over the edge of the work surface or let it touch any hot surfaces.
- ▶ Do not wrap the cord around the appliance.

- ▶ Do not use outdoors or in damp areas.
- ▶ Never carry the unit by its power cord.
- ▶ Do not drop or insert any object into any opening.
- ▶ Never use the appliance to blend anything other than foods.

This appliance is intended to be used in household and similar applications such as:

- ▶ Staff kitchen areas in shops, offices and other working environments
- ▶ Farm houses
- ▶ By clients in hotels, motels and other residential type environments
- ▶ Bed and breakfast type environments

BEFORE USE

1. Remove all packaging and clean the jug, measuring cup and lid thoroughly before using for the first time. Only clean the main unit with a damp cloth. Never immerse the unit in water or place under running water. See cleaning & storage section page 13 & 14 for full cleaning instructions.

 **WARNING:** Never touch the blades while the appliance is plugged in, the blades are sharp. extreme care should be taken when handling.

2. Do not plug in the appliance before assembling.
3. Place the appliance on a flat surface.
4. Place the jug on to the motor unit lining up the markings on the jug and main body and lock into place by turning clockwise.
5. Put the lid on top of the jug and push it down. Insert the measuring cup into the cover and turn until it locks into place.
6. Make sure the appliance is turned off before plugging in.

HOW TO USE

1. Before plugging in ensure that the mains voltage matches that shown on the rating label.
2. This unit has a safety design, it will not work if the jug is not installed onto the main body properly.
3. Turn the control dial to position 0 in order to make sure the unit is turned off.
4. Place ingredients into the jug, do not exceed the maximum 1.5L capacity. Do not operate without any ingredients.
5. Put the lid on top of the jug ensuring it is fitted correctly.

IMPORTANT: Do not open the lid while the blender is working.

6. Turn the control dial clockwise to your desired speed, or use the pulse function by turning the dial anti-clockwise.

Control settings

P - Pulse. The pulse setting will operate at the highest speed, and will only operate when you are holding the switch, as soon as you release the switch the appliance will stop. This is suitable for ice and for when you only want to roughly blend ingredients and you require control so that you don't end up with a really fine mixture.

1 - Low Speed. Will blend continuously on low speed until you return the switch to the off position.

2 - High Speed. Will blend continuously on high speed until you return the switch to the off position.

0 - Off. Will turn off the unit.



7. Turn the dial to the "0/OFF" position when you have finished. Wait for the blender to completely stop.
8. Always ensure the appliance is unplugged after use.
9. Do not operate the appliance continuously for more than 1 minute. Always allow the appliance to cool down to room temperature before continuing.
10. If blending warm liquids remove the measuring cap and start at low speed increasing to high speed if required. The pulse setting is not recommended for warm liquids. Do not blend warm liquids over the 1L level, and always take care to avoid contact with any steam or liquids.



WARNING: ALWAYS COOL HOT LIQUIDS BEFORE BLENDING.

NOTE: It is recommended to cut the meat, vegetables or other food into smaller pieces before putting them in the jug. Large quantities of food should be processed in small batches, do not overload.

USING THE GRINDING ATTACHMENT

1. Make sure the unit is unplugged and turned off before installation of the grinder attachment.
2. The grinder can be used for nuts, dried fruit, bread crumbs etc.
3. Turn grinder upside down and carefully unscrew the blade housing. Carefully remove the blade housing.
4. Fill the grinder with desired ingredients. Do not fill more than half full.
5. Screw the blade housing tightly on to the bowl.

NOTE: If it is not tightly screwed together the motor will not work due to a safety mechanism.

6. Turn the grinder the right way up and lock into place on the motor unit by turning clock wise.
7. Plug the appliance in and select desired speed setting.
8. When the ingredients have been grounded/chopped to the desired consistency, unplug the appliance, and remove the grinding unit from the appliance.

 **WARNING: ALWAYS UNPLUG AND REMOVE THE COMPLETE GRINDING UNIT. DO NOT UNSCREW THE BOWL ON THE UNIT. AS THIS WILL CAUSE THE INGREDIENTS TO SPILL OUT AND EXPOSE THE BLADE UNIT.**

9. Turn the grinder upside down and carefully unscrew the blade housing. Carefully remove the housing and empty the ingredients into a bowl etc.

CLEANING AND STORAGE GRINDER ATTACHMENT

1. Ensure the appliance is turned off and unplugged before cleaning.
2. In addition to the following you must refer to the safety precautions.
3. Turn grinder upside down and carefully unscrew the blade housing. Carefully remove the housing. Clean with hot water and a little mild cleaning agent taking great care as the blades are very sharp.
4. Ensure the bowl and blades are clean, rinse and dry well before re-using.
5. Never use aggressive cleaning agents.

 **WARNING: DO NOT TOUCH THE SHARP BLADES, WHEN CLEANING PLEASE WIPE WITH A CLOTH TO AVOID ACCIDENTAL INJURY.**

CLEANING AND STORAGE BLENDER AND JUG

1. In addition to the following you must refer to the safety precautions.
2. Do not clean motor main body, power cord and plug with water.
3. Clean the main body with a soft, damp cloth and some mild cleaning agent.
4. Fill the jug half-full with warm water and a little cleaning agent. Let the unit run on speed 2 until the jug is clean.
5. Ensure the jug and blades are clean, rinse and dry well before re-using. Caution! The blades inside of the jug are very sharp.
6. Never use aggressive cleaning agents.

 **WARNING: ALWAYS UNPLUG THE MAIN HOUSING AND REMOVE THE COMPLETE JUG ASSEMBLY BEFORE ATTEMPTING TO UNSCREW THE BLADE HOUSING. NEVER PLACE OR STORE THE BLADE HOUSING ON THE MAIN UNIT WHILST REMOVED FROM THE JUG.**

REMOVABLE BLADE HOUSING

To make cleaning of the blades easier the blade housing can be removed. Please ensure that you read the following instructions carefully.

1. Ensure the appliance is turned off and unplugged.
2. Remove the jug assembly from the base. Turn upside down, and twist the blade housing clockwise as indicated by the arrows.
3. Carefully remove the blade housing and wash with mild cleaning agent, taking great care as the blades are sharp.
4. Dry all parts carefully.

TO REASSEMBLE

1. Carefully twist the blade housing anti clockwise back into place as indicated by the arrows ensuring that it is securely tightened.

PRODUCT REGISTRATION

Wahl are constantly developing and launching new products in the UK. We would like to understand your product needs and expectations and we value any comments you may have. As part of Wahl Customer Care, we are offering you the chance to be kept up to date with the latest product launches, innovations and special offers.

Please take a minute to register your product online at **wahl.co.uk**.

GUARANTEE

This product is guaranteed against defects in material and workmanship for a period of twenty four months from the date of original purchase or receipt as a gift.

The guarantee becomes invalid in the case of misuse or repair by unauthorised persons.

Should this product become defective during the warranty period, return it to the store of purchase together with your proof of purchase for repair or replacement without any charges to you. This guarantee in no way affects your rights under statutory law in the United Kingdom.

**WASTE ELECTRICAL &
ELECTRONIC EQUIPMENT
DIRECTIVE 2002/96/EC (WEEE)**



At the end of this products life it should not be disposed of with general household waste. Care should be taken to dispose of in a suitable manner in accordance with your Local Authority regulation.

WIRING

WARNING: If the supply cord is damaged it must be replaced by the manufacturers service agent or a similarly qualified person in order to avoid a hazard.

The wires in the mains lead of this Table Blender are coloured in accordance to the following code:

Blue Neutral (N)

Brown live (L)

This appliance is fitted with a 3 pin plug which has a 13amp fuse fitted.

If the plug supplied is not suitable for your socket or becomes damaged, it should be cut off and disposed of, and a suitable plug fitted as detailed below.

As the colours of the wires in the mains lead of this Table Blender with Grinder may not correspond with the colour markings identifying the terminals in your plug, proceed as follows.

The wire, which is coloured BLUE, must be connected to the terminal in the plug which is marked with the letter 'N' or coloured BLACK or BLUE.

The wire, which is coloured BROWN, must be connected to the terminal in the plug which is marked with the letter 'L' or coloured RED or BROWN.

DO NOT connect either wire to the terminal in the plug which is marked with the letter 'E' or has the Earth symbol, or coloured GREEN or GREEN/YELLOW.

Wahl (UK) Ltd
Herne Bay West Industrial Park
Herne Bay
Kent
CT6 8JZ
www.wahl.co.uk

Customer Service
T: 01227 740066

Form No. ZB166
Rev1 11-17