



WAHL[®]

james
MARTIN

Grind and Chop ZX889

Safety first

The blades of this appliance are extremely sharp, take great care.
Always unplug before adding or removing attachments.
Read all instructions before using for the first time.

Please read all instructions carefully to familiarise yourself
with the
Wahl James Martin Grind and Chop before using.

THIS GRIND & CHOP IS INTENDED FOR HOUSEHOLD USE
ONLY.

Save these instructions for further reference.

For any further assistance or information call customer
services on

T: 01227 740066

or visit

W: www.wahl.co.uk

E: customer.services@wahl.co.uk

CONTENTS

DESCRIPTION OF PARTS	Page 3
IMPORTANT SAFEGUARDS BEFORE FIRST USE	Page 4
HOW TO USE	Page 6
CLEANING AND MAINTENANCE	Page 8
WIRING	Page 9
PRODUCT REGISTRATION	Page 10
GUARANTEE	Page 11

DESCRIPTION OF PARTS

- A:** Lid
- B:** Grinder blade
- C:** Grinder cup
- D:** Chopper blade
- E:** Chopper cup
- F:** Body
- G:** Power cord

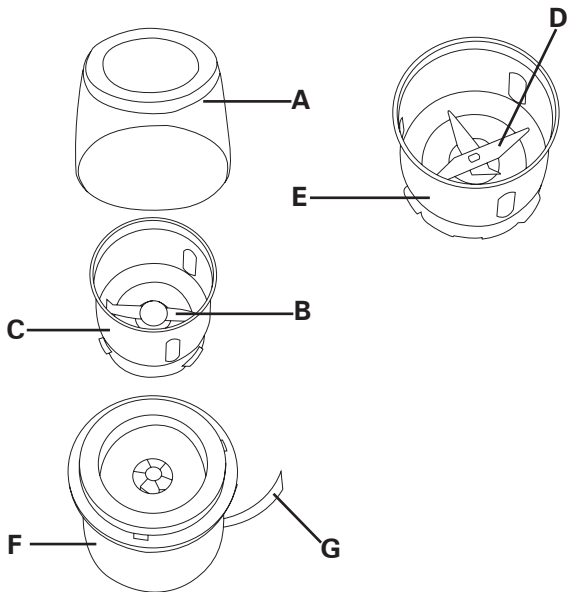

IMPORTANT SAFEGUARDS

When using this electrical appliance, especially when children are present, basic safety precautions should always be observed including the following.

TO REDUCE THE RISK OF FIRE AND INJURY

1. Always disconnect the appliance from the supply if it is left unattended and before assembling, disassembling or cleaning. This appliance shall not be used by children. Keep the appliance and its cord out of reach of children. Appliances can be used by persons with reduced physical, sensory or mental capabilities or lack of experience and knowledge if they have been given supervision or instruction concerning use of the appliance in a safe way and if they understand the hazards involved.

Children shall not play with the appliance.

2. Never touch or allow contact with moving parts while in motion. Keep hands, hair clothing and other utensils away from the moving parts during operation to prevent accident, injury or damage to the appliance.

3. Switch off the appliance and unplug

from outlet when not in use, before putting on or taking off attachments and also before cleaning the appliance.

4. Never use your appliance without paying attention! Always unplug the unit when not in use, even for a moment.

5. Do not operate the appliance with a broken cord or plug, or if the appliance malfunctions, or is dropped or damaged in anyway.

6. Any servicing or repair must be performed by an authorised service representative.

7. Do not use outdoors or in damp areas.

8. Do not let the cord hang over the edge of the work surface or let it touch any hot surfaces.

9. The use of attachments that are not supplied by the manufacturer may cause fire, electric shock or injury and damage to the appliance.

10. To protect against risk of electrical shock, never immerse the unit or let it come into contact with water or any other liquids. Do not use the unit with wet hands. If the appliance should become wet, damp or fall in water, remove plug from mains socket immediately.

Do not put your hands in the water.

11. Never carry the unit by its power cord.

12. Use this appliance only for its intended purpose.

⚠ WARNING: ALWAYS ENSURE THE POWER CORD IS UNPLUGGED FROM THE POWER OUTLET BEFORE ADDING OR REMOVING ANY OF THE ATTACHMENTS.

IMPORTANT: Maximum operation should not exceed 30 seconds.

BEFORE YOUR FIRST USE

Remove all packaging and using the description of parts familiarise yourself with your appliance and the different parts. Check that all the accessories are complete and the unit is not damaged.

Wash the chopper and grinder cups and lid prior to use referring to the cleaning and maintenance section.

Before plugging in check that the voltage matches that shown on the rating label.

⚠ WARNING: THE BLADES ARE SHARP, HANDLE CAREFULLY.

HOW TO USE

The Grinder cup

This is ideal for coffee beans (max capacity 80g) and dry spices.

The Chopper cup

This is ideal for nuts, vegetables, fruit, dry fruit, garlic ginger, herbs etc. A little water or oil may be added if required to combine ingredients.

NOTE: Only use small amounts of liquid to combine ingredients, liquid may spill from the cup if over filled.

1. Place the motor unit on the flat surface. Make sure the power outlet is unplugged.
2. Decide if you are using the grinder cup or chopper cup depending on your ingredients.
3. Place the grinder cup or chopper cup onto the motor unit and following the arrow on the motor unit turn clockwise to lock into position.
4. Put the food into the cup.
5. Place the lid onto the cup.
6. Plug the appliance into the power outlet.
7. Push the lid down and hold down to operate the appliance.
8. Once the ingredients are at the desired consistency to stop grinding release the pressure from the lid.
9. Always unplug the appliance after use.

TIPS FOR CHOPPING

1. Ensure food pieces are not too large about 2cm or smaller is ideal.
2. Even sized pieces will give more consistent results.
3. When using the chopper you can add a little liquid such as oil, water or vinegar to help combine the ingredients and make a paste or sauce.
4. This appliance will chop and combine ingredients

very quickly, so use short sharp pulse actions to see how fine your ingredients are, so that you achieve the desired results.

5. When chopping certain ingredients you may need to use a small spatula or similar to scrape food from the sides and return to the centre.

TIPS FOR GRINDING

1. The grinder attachment is designed for dry ingredients. Wet or oily ingredients will work better in the chopper.
2. If grinding small quantities a pulse action will give a more even and effective result.
3. Most items do not require much grinding to achieve the desired effect.
4. Really hard ingredients such as Nutmeg should not be used in the grinder.

NOTE clean immediately after use to avoid strong flavours lingering and contaminating other ingredients.

CLEANING AND MAINTENANCE

1. Unplug the appliance and remove grinder and chopping cups.
2. Wash the cups in warm soapy water taking care not to touch the blades. The cups can be washed in the dishwasher, however, the printed text will be eroded on the cups over time.

 **WARNING: THE BLADES ARE SHARP, HANDLE CAREFULLY.**

3. Dry thoroughly.
4. Wipe the motor unit with a damp cloth.

 **WARNING:** NEVER IMMERSE THE MOTOR UNIT IN WATER OR ANY OTHER LIQUID.

WIRING

WARNING: IF THE SUPPLY CORD IS DAMAGED IT MUST BE REPLACED BY THE MANUFACTURERS SERVICE AGENT OR A SIMILARLY QUALIFIED PERSON IN ORDER TO AVOID A HAZARD.

The wires in the mains lead of this Food Processor are coloured in accordance to the following code:
Blue Neutral (N) Brown live (L)

This appliance is fitted with a 3 pin plug which has a 5amp fuse fitted.

If the plug supplied is not suitable for your socket or becomes damaged, it should be cut off and disposed of, and a suitable plug fitted as detailed below.

As the colours of the wires in the mains lead of this Food Processor may not correspond with the colour markings identifying the terminals in your plug, proceed as follows. The wire which is coloured BLUE must be connected to the terminal in the plug which is marked with the letter 'N' or coloured BLACK or BLUE.

The wire which is coloured BROWN must be connected to the terminal in the plug which is marked with the letter 'L' or coloured RED or BROWN.

DO NOT connect either wire to the terminal in the plug which is marked with the letter 'E' or has the Earth symbol, or coloured GREEN or GREEN/YELLOW

WASTE ELECTRICAL & ELECTRONIC EQUIPMENT DIRECTIVE 2002/96/EC (WEEE)



At the end of this products life it should not be disposed of with general household waste. Care should be taken to dispose of in a suitable manner in accordance with your Local Authority regulation.

PRODUCT REGISTRATION

Wahl are constantly developing and launching new products in the UK. We would like to understand your product needs and expectations and we value any comments you may have. As part of Wahl Customer Care, we are offering you the chance to be kept up to date with the latest product launches, innovations and special offers.

Please take a minute to register your product online at www.wahl.co.uk.

GUARANTEE

This product is guaranteed against defects in material and workmanship for a period of 2 years from the date of original purchase or receipt as a gift.

Should this product become defective during the guarantee period, return it to the store of purchase together with your proof of purchase for repair or replacement

Alternatively within the guarantee period you can return the product to Wahl (UK) Ltd who will repair any such defect or elect to replace the product or any part of it, without charge, provided that there is proof of purchase. Should a replacement be offered this will not extend the original guarantee period.

The guarantee becomes invalid in the case of misuse, alteration or repair by unauthorised persons.

This product is designed for domestic use only and use within a professional environment will invalidate the guarantee.

This guarantee in no way affects your rights under statutory law in the United Kingdom.

Wahl (UK) Ltd
Herne Bay Trade Park
Herne Bay
Kent
CT6 8JZ
www.wahl.co.uk

Customer Service T: 01227 740066

Form No. ZB537
Rev1 09-15



james
MARTIN