



## Rechargeable Trimmer Instructions

Please read all instructions carefully to familiarise yourself with the Wahl Rechargeable Trimmer before using.

Save these instructions for further reference.

For any further assistance or information call customer services on

**T:** 01227 740066

or visit

**W:** [www.wahl.co.uk](http://www.wahl.co.uk)

**E:** [customer.services@wahl.co.uk](mailto:customer.services@wahl.co.uk)

### CONTENTS

<b>IMPORTANT SAFEGUARDS</b>	Page 3
<b>OPERATING INSTRUCTIONS</b>	Page 5
<b>SPECIAL FEATURES</b>	Page 6
<b>USING YOUR TRIMMER</b>	Page 7
<b>WIRING</b>	Page 11
<b>BATTERY REPLACEMENT, REMOVAL AND DISPOSAL</b>	Page 12
<b>PRODUCT REGISTRATION</b>	Page 13
<b>GUARANTEE</b>	Page 14

Please retain this leaflet for future reference.

READ ALL INSTRUCTIONS BEFORE USING.

#### IMPORTANT SAFEGUARDS

When using your electrical appliance, basic safety precautions should always be followed, including the following:

1. This appliance can be used by children from aged 14 years and above and persons with reduced physical, sensory or mental capabilities, or lack of experience and knowledge, if they have been given supervision or instruction concerning use of the appliance in a safe way and understand the hazards involved. Children shall not play with the appliance. Cleaning and user maintenance shall not be made by children without supervision.
2. Switch off the appliance and unplug from outlet when not in use, before putting on or taking off attachments and also before cleaning the appliance.
3. Never use your appliance without paying attention! Except when charging always unplug this appliance from the electricity outlet immediately after using.
4. Do not operate the appliance with a broken cord, plug or charger, or if the appliance malfunctions, or is dropped or damaged in

anyway.

5. Do not wrap the cord around the appliance.
6. Any servicing or repair must be performed by an authorised service representative.
7. Do not use outdoors or in damp areas.
8. The use of attachments that are not supplied by the manufacturer may cause fire, electric shock or injury and damage to the appliance.
9. To protect against risk of electrical shock, never immerse the unit or let it come into contact with water or any other liquids. Do not use the unit with wet hands. If the appliance should become wet, damp or fall in water, remove plug from mains socket immediately. Do not put your hands in the water. Do not take into bathroom.
10. Never carry the unit by its power cord.
11. Do not drop or insert any object into any opening.
12. Use this appliance only for its intended purpose.
13. Exhausted batteries/ rechargeable batteries should not be disposed of in the household waste. Dispose of them in a completely discharged state in accordance with local legal regulations. Do not throw into fire where heat could cause them to rupture.

## OPERATING INSTRUCTIONS

**IMPORTANT:** Only use transformer supplied

1. This trimmer is conveniently designed for household use. It should be allowed to charge overnight before first use.
2. Remove the trimmer, transformer and accessories from packaging material.
3. Connect the transformer to the trimmer.  
**BE SURE THE TRIMMER IS IN THE OFF POSITION WHEN CHARGING.**
4. Plug the recharging transformer into any convenient electrical outlet at the correct voltage.
5. When trimmer is low in power, it should be connected to the transformer and plugged into an outlet to assure maximum power is available when next used. This transformer is designed to continuously charge the battery without over charging.
6. NiMH battery life may be extended with the following procedure: Once every month, let the trimmer run until the motor stops. Move the switch to the OFF position and recharge fully overnight.

### TROUBLE SHOOTING

If your trimmer does not seem to take a charge, check the following before returning for repair.

1. Check outlet current by plugging in another appliance.
2. Make sure the outlet supply is not connected to a light switch which turns the power at the outlet off when the lights are turned off.
3. Be sure the trimmer is properly connected to the recharging transformer, all connections are secure and the switch on the trimmer is OFF.
4. If your electricity is connected to a master power switch, we suggest the trimmer be disconnected from the

5

anywhere to define the hair line and clip any stray whiskers. To remove the attachment, simply pull the edge of the blade away from the body of the unit. To attach, align back tab attachment head to cavity on the inner edge of the trimmer unit.

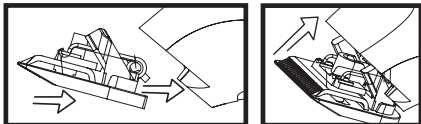

### USING YOUR TRIMMER TRIMMING AND EDGING YOUR BEARD

The following are suggested trimming steps and trimming positions. You may find different procedures work better for you.

1. Comb your beard in the direction that it grows to help reveal stray hairs that may be longer than others.
2. Attach the 5 position guide to trim and taper your beard. Begin with the guide set at a long trimming length. Trim toward your chin in smooth, overlapping strokes, following the lay of your beard. If you trim against the way your beard naturally lays, the trimmer will cut the hair much shorter and the result may be patchy. Adjust the trimming guide to progressively shorter settings until you reach the desired length of beard. You may wish to set the trimming guide attachment to cut closer near the ear and down under the chin, changing to a longer setting toward the front of the face and point your chin. When the trimming guide is removed, it will remain at its last length setting until you change it. Always be sure the trimming guide is locked solidly into the desired position before you start to trim.
3. To cut the outline of your beard, remove the trimming guide. Starting under your chin and working back toward your jawbone and ears, cut the outer perimeter of your

7

charger anytime the master switch is off. Leaving the unit unplugged into a dead outlet or an unplugged charger may drain the battery.

5. If the trimmer does not run and its completely charged, turn the unit ON and pinch or push the blades manually. (Oil may have dried out between the blades, so they may be temporarily stuck together).

### SPECIAL FEATURES:

A 5 position trimming guide makes achieving a consistent trim every time.

The guide can be removed (providing a sixth cutting position) and reattached without changing the preset cutting length, so once you have found the perfect length, there is no guesswork in achieving it every time. The trimming guide is a two piece assembly, consisting of a base and a comb. It should not be disassembled. To attach the guide, simply slide it on at a slight angle and press the release tab down to secure in position.

To remove the guide, gently push up on the release tab and slide the assembly away from the trimmer. Adjust the trimming length by pressing on the thumb lever and moving the comb forward or backward to the desired setting.

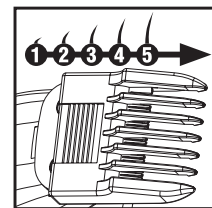

A detachable blade system enables you to quickly change from a standard width blade for full grooming to a narrow blade for detail trimming around a goatee, moustache or

6

beard underneath the jaw bone. Continue the line all the way up to the ears and hairline.

4. Accentuate your beard line by using the trimmer in a downward motion. Start at the line you've created and working from the chin back toward ears, trim the area right under your beard line.
5. Define the upper part of your beard using the same technique.
6. For a neater finished look, replace attachment blade with the detail blade. Use this blade for fine, detail trimming anywhere it is needed, such as the sideburns near the ears and goatees.

### DETAILING NECKLINES, SIDEBURNS

Slowly move trimmer downward on desired areas to neatly trim and shape.

### TRIMMING ARM AND LEG HAIR

Simply guide the trimmer over your arm or leg until desired hair length is achieved.

### TRIMMING CHEST AND STOMACH

Glide the trimmer over your torso region, in an upward motion until desired hair length is achieved. For tight, scratch free trimming, use the #1 guide comb.

### TRIMMING NOSE HAIR

Make sure the nasal passages are clean. Slowly move the detailer in and out of each nostril, no more than a 6mm deep.

### TRIMMING EAR HAIR

Make sure the outer areas of ears do not contain any wax. Hold the ear flat with one hand and carefully insert head no more than 6mm into the outer ear.

8

**⚠ WARNING: DO NOT INSERT THE HEAD OR ANY FOREIGN OBJECT INTO THE INNER EAR. FOR HAIR GROWING ON THE OUTSIDE OF THE EAR, SIMPLY MOVE THE HEAD SLOWLY ALONG THE EDGES OF THE EAR.**

### TRIMMING WITH ATTACHMENT COMBS

Your trimmer includes three attachments, stubble, medium and long. The stubble guide has 1 bar, the medium-cut has 2 bars and the long attachment has 3 bars. These attachments are ideal for blending, tapering and defining beards, as well as for achieving a close trim stubble look around the face.

### OILING BLADES

For best results, put one or two drops of Wahl clipper oil on the blades (A & B) before and after every use. When oiling the trimmer, turn the trimmer ON, hold the unit facing down and squeeze one or two drops of oil onto the blades. Wipe off excess oil with a cloth.

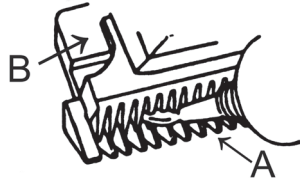

**IMPORTANT:** Do not over Oil!

Excessive oiling or application of liquids will cause damage if allowed to seep back into the motor.

### BLADE CARE

Trimmer blades have precision-hardened, ground and lapped cutting teeth. Blades should be handled carefully and never bumped or used the cut dirty abrasive material. Should blades

9

### WIRING

**⚠ WARNING: IF THE TRANSFORMER IS DAMAGED IT MUST BE REPLACED IN ORDER TO AVOID A HAZARD. THIS PRODUCT MUST ONLY BE USED WITH THE TRANSFORMER SUPPLIED. SHOULD A REPLACEMENT BE REQUIRED CONTACT WAHL CUSTOMER SERVICES.**

WASTE ELECTRICAL & ELECTRONIC EQUIPMENT  
DIRECTIVE 2002/96/EC (WEEE)



At the end of this products life it should not be disposed of with general household waste. Care should be taken to dispose of in a suitable manner in accordance with your Local Authority regulation.

11

become dull or damaged, you may purchase a new blade assembly from Wahl. Be sure to ask for the Groomsmen Blade Assembly.

### BATTERY REPLACEMENT, REMOVAL AND DISPOSAL

#### Battery Replacement

For battery replacement the entire, intact trimmer should be sent to: Wahl (UK) Ltd Customer Services (the address can be found on the reverse of this booklet) or taken to a suitably qualified professional. The battery should only be replaced by the original manufacturers spare.

#### Battery Removal and Disposal

At the end of its life, when it will no longer take a full charge, the battery in your trimmer must be removed and recycled/disposed of correctly. Batteries should be disposed of at an official collection point. If you are having trouble removing the battery you can also return the product to Wahl (UK) Ltd Customer services who will dispose of it in an environmentally safe way.

To remove the battery follow these steps:

1. Unplug the transformer from the outlet, disconnect from the trimmer and allow the batteries to completely run down before disassembly.
2. Using a screwdriver, pry the chrome cover away from the housing.
3. Remove the screws from the housing.
4. Pull the trimmer apart.
5. Cut or break the wire stamps on both ends of the battery and remove the battery.
6. Apply tape to both ends of the battery before recycling/disposing.

10

12

## PRODUCT REGISTRATION

Wahl are constantly developing and launching new products in the UK. We would like to understand your product needs and expectations and we value any comments you may have. As part of Wahl Customer Care, we are offering you the chance to be kept up to date with the latest product launches, innovations and special offers. Please take a minute to register your product online at [www.wahl.co.uk](http://www.wahl.co.uk).

13

## GUARANTEE

This product is guaranteed against defects in material and workmanship for a period of 3 years from the date of original purchase or receipt as a gift.

Should this product become defective during the guarantee period, return it to the store of purchase together with your proof of purchase for repair or replacement.

Alternatively within the guarantee period you can return the product to Wahl (UK) Ltd who will repair any such defect or elect to replace the product or any part of it, without charge, provided there is proof of purchase. Should a replacement be offered this will not extend the original guarantee period.

The guarantee becomes invalid in the case of misuse, alteration or repair by unauthorised persons.

This guarantee does not include blades, cables, shaver heads, foils and cutters etc which are consumable parts.

This product is designed for domestic use only and use within a professional environment will invalidate the guarantee.

This guarantee in no way affects your rights under law in the United Kingdom.

14

Wahl (UK) Ltd  
Herne Bay Trade Park  
Herne Bay  
Kent  
CT6 8JZ  
[www.wahl.co.uk](http://www.wahl.co.uk)

Customer Service T: 01227 740066  
Form No. 58985-001  
Rev0 05-15